

PRG10 Series

Single Output DC/AC Converter

Features

- Industry standard footprint:
2"x2"x0.5"(50.8x50.8x12.7mm)
- Typical efficiency: 75%
- Single output: 75Vac
- Wide input voltage range:38-62Vdc
- Output over-current, short-circuit protection
- Input under-voltage shutdown
- Remote control
- No minimum load requirement
- Basic Isolation

Environmental

- Operating ambient temperature range:
-25°C to 55°C
- Operating board temperature range:
-55°C to 125°C
- Storage temperature range:
-55°C to 125°C
- Temperature coefficient:
$\lt; \pm 0.8\%/^{\circ}\text{C}$
- MTBF:
>2 million hrs

Electrical Specifications

Input

Input range:	38-62Vdc
Input under-voltage shutdown:	32-35.5Vdc

Output

Voltage setpoint accuracy:	69-81Vac max
Voltage adjust:	None
Line regulation:	0.5%Vo max
Load regulation:	1.0%Vo max
Short-circuit protection:	continuous,hiccup
Over-current protection:	0.19-0.22A, hiccup

Control

Control voltage:	
Negative logic	
Low =on	-0.3 to 1.0Vdc
High=off	4.0 to Vin
Control current::	2mA max



Ordering Information

Input Voltage	Output Voltage	Output Current	Efficiency	Model Number
48Vdc	75Vac	0.14A	75%	PRG10-48S75NY

Dimensions

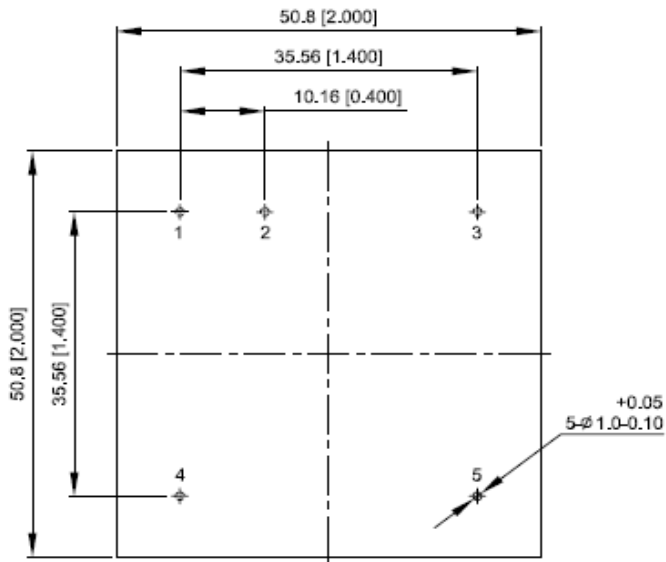

Top View

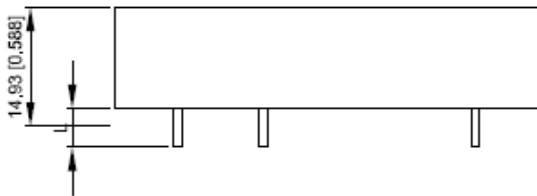

TOLERANCES: X.Xmm=±0.5mm
X.XXmm=±0.25mm

Unit:mm[inch]

Pin Assignments

1	+Vin
2	CNT
3	-Vin
4	VO1
5	VO2