

PEH/PMH Series 50W/100W/150W Half Brick Single Output DC/DC Converter

Features

- Industry standard footprint:
2.4"x2.28"x0.39"(61.0 x 57.9 x 9.8mm³)
- Typical efficiency: 90%
- 2:1 wide input voltage range:
18-36V,36-75V
- Single output:
1.2V,1.5V,1.8V,2.5V,3.3V,5V
- Remote control ;Trim and sense function
- Input under-voltage shutdown
- Output over-current ,over-voltage,
short-circuit protection
- Over-temperature protection
- No minimum load requirement

Environmental

- Operating ambient temperature range:
-40°C to 55°C
- Operating board temperature range:
-40°C to 100°C
- Storage temperature range:
-55°C to 125°C
- Over-temperature protection:
>120°C typical
- Temperature coefficient:
<±0.02%/°C
- MTBF:
>2 million hrs

Electrical Specifications

Input

Input range:	18-36V;36-75V
Input under-voltage shutdown:	15-16.5V;32-35V

Output

Voltage setpoint accuracy:	±1.0%Vo max
Voltage adjust:	90% to 110%Vo
Line regulation:	5mV max
Load regulation:	15mV max
Over-current protection:	>110%Io, auto-recovery (or latch off)
Over-voltage protection:	>110%Vo, latch off (or auto-recovery)
Short-circuit protection:	Continuous, auto-recovery (or latch off)
Ripple and noise:	<150mVpp max
Transient response:	200mV max recovery<250us max (25%~50%~25% Iomax) di/dt: 1A/10uS

Control

Control voltage:	
Positive logic	
High =on	3.5 to 10Vdc
Low=off	-0.7 to 1.5Vdc
Negative logic	
Low =on	-0.7 to 1.5Vdc
High=off	3.5 to 10Vdc
Control current::	2mA max

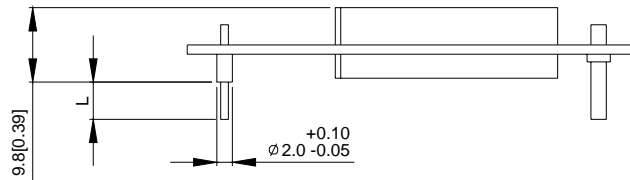
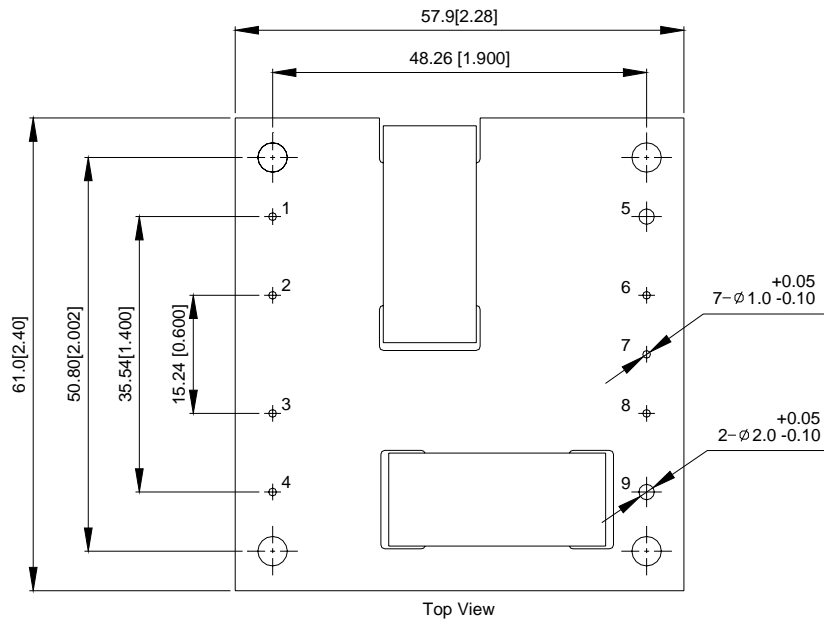

PMH Serise

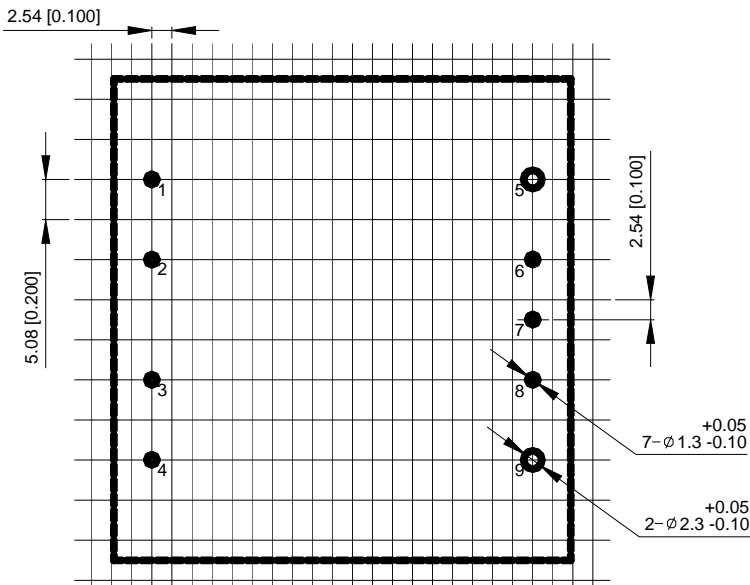

Pin Assignments

1	+Vin		
2	CNT	Pin Length:	
3	Case	4.8mm	-4
4	-Vin	3.8mm	-6
5	+Vo	2.8mm	-8
6	+Sense	5.8mm	None
7	Trim		
8	-Sense		
9	-Vo		

TOLERANCES: X.Xmm=+/-0.5mm
X.XXmm=+/-0.25mm

Unit:mm[inch]